

| Nr. | Denumire incapere | Suprafata utila (mp) |
|-----|-------------------|----------------------|
| 1 | Grup Sanitar | 13.0 |
| 2 | Grup Sanitar | 12.7 |
| 3 | Salon | 8.2 |
| 4 | Grup sanitar | 13.8 |
| 5 | Grup sanitar | 3.3 |
| 6 | Salon | 3.3 |
| 7 | Grup sanitar | 14.3 |
| 8 | Grup sanitar | 3.7 |
| 9 | Grup sanitar | 2.9 |
| 10 | Salon | 14.0 |
| 11 | Salon | 21.5 |
| 12 | Salon | 22.7 |
| 13 | Salon | 23.0 |
| 14 | Bucatarie | 8.3 |
| 15 | Hol | 5.2 |
| 16 | Sala masa | 22.7 |
| 17 | Cabinet asistente | 18.8 |
| 18 | Grup Sanitar | 2.9 |
| 19 | Cabinet medic | 13.0 |
| 20 | Salon | 22.2 |
| 21 | Grup Sanitar | 14.5 |
| 22 | Grup Sanitar | 3.0 |
| 23 | Salon | 14.2 |
| 24 | Grup Sanitar | 6.8 |
| 25 | Grup Sanitar | 9.9 |
| 26 | Grup Sanitar | 9.3 |
| 27 | Hol | 65.0 |
| 28 | Hol | 19.2 |
| 29 | Hol | 84.0 |
| 30 | Hol | 39.3 |
| 31 | Salon | 31.4 |
| 32 | Hol | 12.8 |
| 33 | Salon | 8.4 |
| 34 | Salon | 8.2 |
| 35 | Salon | 31.3 |

| | | |
|----------------------------|----------------------------|------|
| 36 | Salon | 31.1 |
| 37 | Hol | 12.7 |
| 38 | Salon | 8.2 |
| 39 | Salon | 8.2 |
| 40 | Salon | 32.0 |
| 41 | Magazie | 1.8 |
| 42 | Grup sanitar | 1.6 |
| 43 | Magazie | 2.0 |
| 44 | Camera sterilizare | 8.0 |
| 45 | Hol | 3.5 |
| 46 | Camera sterilizare | 8.7 |
| 47 | Grup Sanitar | 3.5 |
| 48 | Grup Sanitar | 4.8 |
| 49 | Depoziti deseuri | 2.1 |
| 50 | Hol | 33.4 |
| 51 | Magazie | 2.2 |
| 52 | Depoziti curatare | 4.6 |
| 53 | Hol | 18.5 |
| 54 | Salon | 23.8 |
| 55 | Salon | 28.4 |
| 56 | Salon | 24.5 |
| 57 | Camera centrala incalzirii | 1.6 |
| 58 | Magazie | 1.6 |
| 59 | Magazie | 1.9 |
| 60 | Hol | 7.6 |
| 61 | Salon | 12.1 |
| 62 | Salon | 31.1 |
| 63 | Hol | 12.4 |
| 64 | Salon | 8.2 |
| 65 | Salon | 8.5 |
| 66 | Salon | 30.7 |
| Suprafata Utila = 981.0 mp | | |
| 67 | Casa scari | 20.7 |
| 68 | Casa scari | 20.3 |
| 69 | Casa lift | 7.1 |
| 70 | Casa lift | 7.1 |

- INLOCUIRE GRESIE SI FAIANTA (PANA LA H=2.10 M) CU LINOLEUM MEDICAL ANTIDERAPANT, TARKET
- REFACERE ZIDURI (DE LA H=2.10 PANA IN TAVAN)
- REFACERE TAVAN SI ADAUGARE PLAFON CASETAT
- INLOCUIRE TAMPLARIE SI REDIMENSIONARE GOLURI USI
- MODERNIZARE LIFT

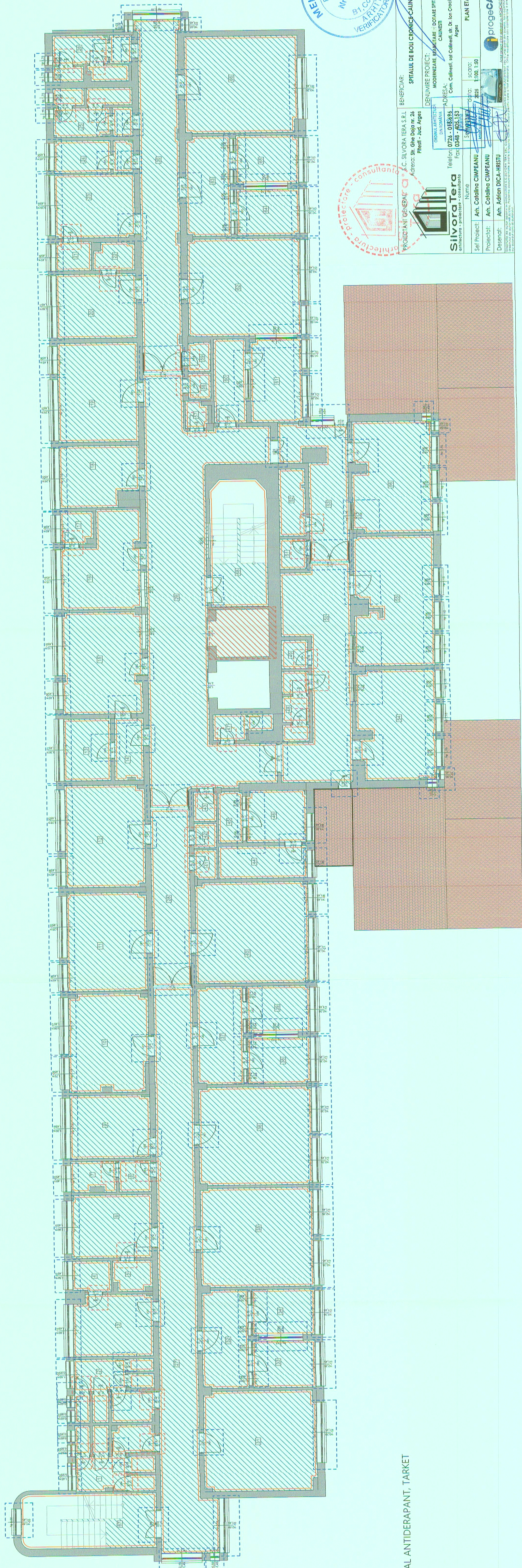

MEITA V. VASILE
ROMANIA
M.D.R.7
Nr. 08949
B1 CODE E
VERIFICATOR PROIECTE

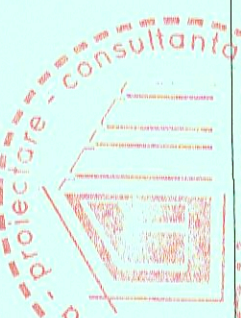

PROIECTANT GENERAL: S.C. SILVORA TERA S.R.L.
Adresa: Str. Ghe. Doja nr. 28
Ploiesti - Jud. Arges

BENEFICIAR: SPITALUL DE BOI CRONICE-CAIUNESTI

DENUMIRE PROIECT: MODERNIZARE SI DOTARE SPITALUL DE BOI CAIUNESTI

ADRESA: Com. Caiunesti sat Caiunesti, str. Dr. Ion Crestin, nr. 484, Jud. Arges

ORDINUL ARHITECTURII: 0726 - 018389

TELEFON: 0348 - 405.153

FOAX: 0348 - 405.153

SEF PROIECT: Arh. Catalina CIMPEANU

PROIECTAT: Arh. Catalina CIMPEANU

DESINAT: Arh. Adrian DICA-HRESTU

PLAN ETAJ 2 PROPUS

SCALA: 1:100, 1:50

PROIECT CAD